

GERBER MANUFACTURING LTD  
PARTS LIST AND ASSEMBLY INSTRUCTIONS  
HANDICAP ACCESSIBLE  
ALL SERIES TABLES

**PARTS**

**SINGLE OVERHANG-LAG SCREWS**

- 1- ADA END FRAME 30" HIGH (EXTRA LEG TIE)
- 1- ADA END FRAME 30" HIGH (ONE LEG TIE)
- 2- 30" BRACES
- 1- 27" BRACE
- 1- REGULAR CENTER CHANNEL
- 1- ADA CENTER CHANNEL
- 56- LAG SCREWS
- 5- 5/16" X 1" BOLTS, NUTS AND LOCKWASHERS
- 5- 2 X 10" OF DESIRED LENGTH (3) 8' TOPS, (2) 6' BENCHES

**TOOLS REQUIRED**

(SAME FOR ALL TABLES)

- CARPENTER SQUARE
- TAPE MEASURE
- WRENCH OR SOCKET SIZE
- 1/4" CARRIAGE = 7/16"
- 5/16" CARRIAGE = 1/2"
- 3/8" CARRIAGE = 9/16"
- FOR LAGS USE 7/16"
- HAMMER

**DOUBLE OVERHANG-LAG SCREWS**

- 2- ADA END FRAMES 30" HIGH (EXTRA LEG TIES)
- 2- 30" BRACES
- 2- 27" BRACES
- 1- REGULAR CENTER CHANNEL
- 2- ADA CENTER CHANNEL
- 66- LAG SCREWS
- 7- 5/16" X 1" BOLTS, NUTS AND LOCKWASHERS
- 5- 2 X 10" OF DESIRED LENGTH (3) 10' TOP, (2) 6' BENCHES

**DOUBLE & SINGLE OVERHANG- DRILLED LUMBER-CAR. BOLTS**

BOLTS REQUIRED AS FOLLOWS:

- ~~32~~ CARRIAGE BOLTS *on Single Overhang 38-CARRIAGE Bolts on DOUBLE Overhang*
- 16S & 11S USE 1/4" X 2"
- 158 SERIES USES 5/16" X 2"
- 238 SERIES USES 3/8" X 2"

- 7- 5/16" X 1" BOLTS, NUTS & LOCKWASHERS ON DOUBLE OVERHANG
- 5- 5/16" X 1" BOLTS, NUTS, & LOCKWASHERS FOR SINGLE OVERHANG

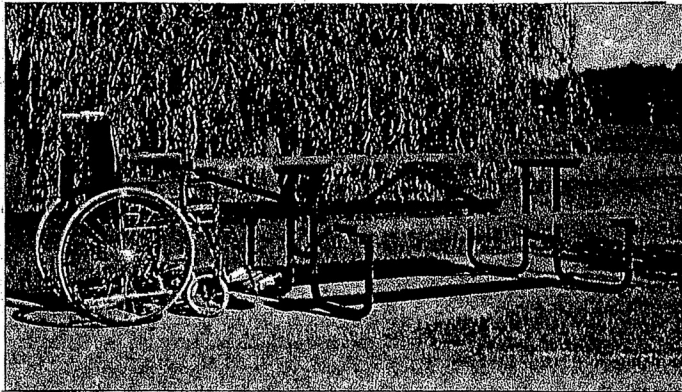

**ASSEMBLY INSTRUCTIONS-SINGLE OVERHANG (8' TOP, 6' SEATS)  
FOR DOUBLE OVERHANG INSTRUCTIONS SEE #6 ON REVERSE.  
IF LUMBER NEEDS TO BE DRILLED FOR CARRIAGE BOLTS, USE  
END FRAME AS A TEMPLATE TO LAY OUT HOLES FOR DRILLING.  
DRILL SIZE WILL BE 1/16" LARGER THAN BOLT DIAMETER. DRILL  
TWO HOLES FOR EACH END OF BOARD AND TWO HOLES PER  
BOARD FOR CENTER CHANNEL. PROCEED WITH THE FOLLOWING  
INSTRUCTIONS.  
IF USING LAG SCREWS, PROCEED WITH STEP THREE.**

- 1) LAYOUT LUMBER FOR TOP ASSEMBLY,(3- 2 X 10'S) ON A CLEAN, LEVEL SURFACE BEST SIDE DOWN. LEAVE 1/4" SPACING BETWEEN BOARDS. KEEP ENDS FLUSH.
- 2) IF LUMBER IS PREDRILLED, BOARDS WILL BE MARKED WITH "L,C,R," FOR THE TOP ASSEMBLY, SEAT BOARDS WILL BE MARKED WITH AN "S". PLACE CARRIAGE BOLTS IN HOLES & TAP HEAD OF BOLTS LIGHTLY TO SEAT CARRIAGE HEAD INTO LUMBER. SQUARE UP TOP ASSEMBLY & FASTEN ALL HARDWARE AS FOLLOWS.
- 3) ATTACH CENTER CHANNEL THAT HAS TAB WELDED PERPENDICULAR TO CHANNEL, (ADA CENTER CHANNEL). SQUARE UP CENTER CHANNEL FROM END OF TABLE TOP MATERIAL TO EITHER SIDE OF TOP ASSEMBLY. LOCATE EQUALLY FROM EACH SIDE AND 8" FROM END OF LUMBER TO CENTER LINE OF HOLES IN CENTER CHANNEL. FASTEN SECURELY WITH (10) 1/4"X 1 1/4" LAG SCREWS.
- 4) ATTACH 27" BRACE TO EAR OF CENTER CHANNEL. ALL FASTENING POINTS OF BRACES USE A 5/16" BOLT, NUT, AND LOCKWASHER. FINGER TIGHTEN ONLY! ATTACH OTHER END OF BRACE TO THE END FRAME WHICH HAS TWO ANGLE IRONS BETWEEN THE UPRIGHTS OF THE FRAME. FASTEN ON ANGLE IRON NEAREST TABLETOP. FINGER TIGHTEN ONLY.
- 5) ATTACH 30" BRACE TO SAME END FRAME AT THE ANGLE IRON FARTHEST FROM TABLE TOP SURFACE. FASTEN OTHER END OF BRACE TO REGULAR CENTER CHANNEL ALONG WITH THE REMAINING 30" BRACE.
- 6) FOR A SINGLE OVERHANG ASSEMBLY ATTACH OTHER END OF 30" BRACE TO REMAINING END FRAME WHICH HAS ONE ANGLE IRON BETWEEN THE UPRIGHTS OF THE FRAME. THEN PROCEED TO STEP 7.  
FOR A DOUBLE OVERHANG ASSEMBLY ATTACH OTHER END OF 30" BRACE TO REMAINING END FRAME WHICH HAS TWO ANGLE IRONS BETWEEN THE UPRIGHTS OF THE FRAME. FASTEN 30" BRACE TO ANGLE IRON FARTHEST AWAY FROM TABLE TOP SURFACE. FINGER TIGHTEN ONLY. ATTACH 27" BRACE TO ANGLE IRON NEAREST TABLE TOP SURFACE. FASTEN OTHER END OF 27" BRACE TO REMAINING CENTER CHANNEL WITH TAB WELDED PERPENDICULAR TO CENTER CHANNEL, (ADA CENTER CHANNEL). SQUARE UP CENTER CHANNEL TO EITHER SIDE OF TOP ASSEMBLY AND FASTEN SECURELY WITH (10) 1/4"X 1 1/4" LAG SCREWS.
- 7) SQUARE UP END FRAMES & LOCATE INTO PLACE REGULAR CENTER CHANNEL ON SURFACE OF LUMBER.
- 8) SECURE END FRAMES AND REGULAR CENTER CHANNEL WITH EITHER LAG SCREWS (12 LAG SCREWS PER END FRAME- 10 LAG SCREWS FOR CENTER CHANNEL) OR (6) CARRIAGE BOLTS PER END FRAME AND (6) CARRIAGE BOLTS PER CENTER CHANNEL.
- 9) FOR FASTENING SEAT BOARDS ON A SINGLE OVERHANG, LOCATE SEAT BOARD TO BE FLUSH WITH TABLE TOP AT OPPOSITE END OF OVERHANG. SECURE SEAT BOARDS WITH EITHER 9 LAG SCREWS OR 4 CARRIAGE BOLTS PER SEAT BOARD. DRILL 4 HOLES, 1/16" LARGER THAN BOLT DIAMETER. FOR FASTENING SEAT BOARDS FOR DOUBLE OVERHANG LOCATE SEAT BOARDS TO BE AN EQUAL DISTANCE FROM EACH BOARD END TO EDGE OF END FRAME. SECURE SEATS WITH EITHER 9 LAG SCREWS OR 4 CARRIAGE BOLTS PER SEAT BOARD. FOR CARRIAGE BOLT APPLICATION DRILL 4 HOLES 1/16" LARGER HOLE THAN CARRIAGE BOLT DIAMETER.
- 10) USING APPROPRIATE WRENCH OR SOCKET SECURE ALL HARDWARE TIGHTLY.

**IF YOU HAVE ANY QUESTIONS REGARDING THE ASSEMBLY OF THIS TABLE  
PLEASE CALL (800) 393-9923.**

**REV 3-21-00**

**THANK YOU FOR PURCHASING A GERBER!**

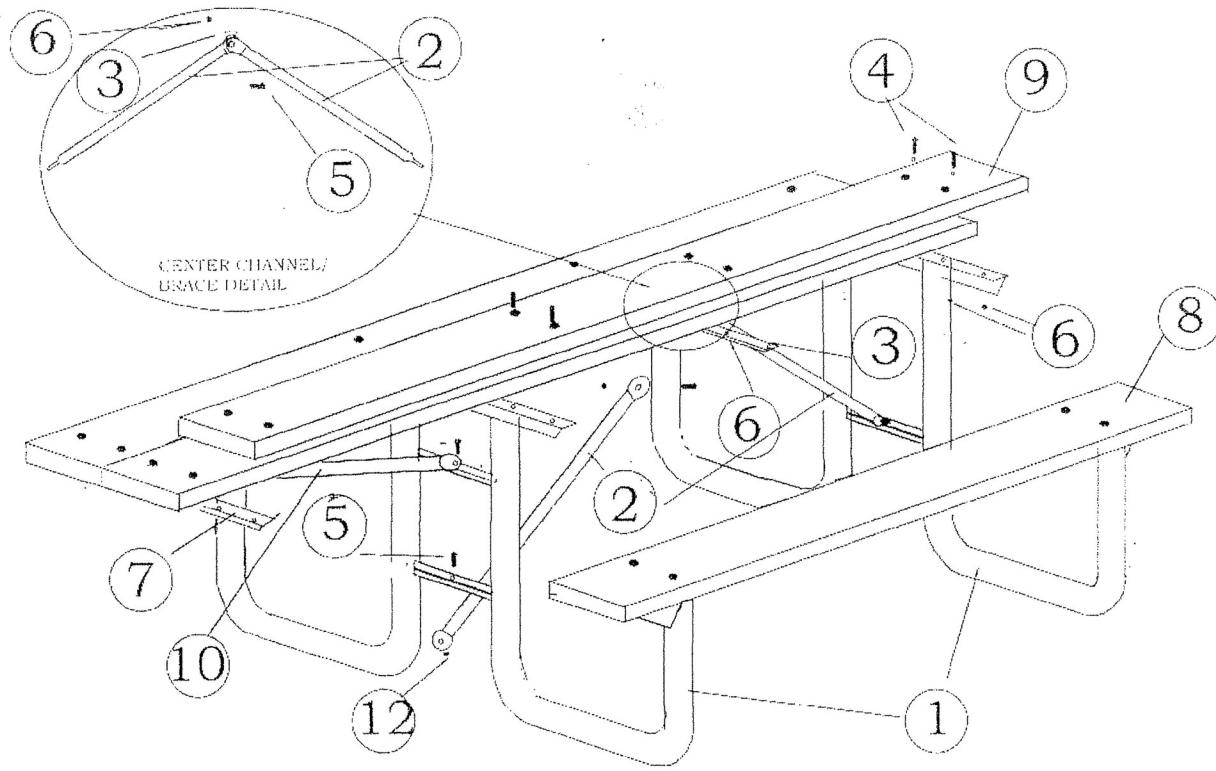

1. LAY 3 - 8' PLANKS, GOOD SIDE DOWN, ON FLAT CLEAN SURFACE WITH 2" CARRIAGE BOLTS INSERTED. NOTE: PLANKS ARE MARKED: "R" RIGHT TOP, "C" CENTER TOP, "L" LEFT TOP, "S" SEAT BOARDS.
2. ATTACH END FRAMES, USING 12 - 2" BOLTS.
3. ATTACH CENTER CHANNEL, USING 6 - 2" BOLTS.
4. ATTACH DIAGONAL BRACES, USING 3 - 1" BOLTS.
5. ATTACH SEAT PLANKS, USING 4 - 2" BOLTS. THE "S" SHOULD BE ON THE SAME END AS "R" "C" "L".
6. TIGHTEN ALL HARDWARE.

- NOTE:  
IF YOU HAVE PURCHASED THE LUMBER LOCALLY OR FROM US, NOT DRILLED, AND ARE USING CARRIAGE BOLTS PRE-DRILL AS FOLLOWS:
- A1. LAY 3 - PLANKS, GOOD SIDE DOWN SPACED 1/4" APART ON A FLAT CLEAN SURFACE.
  - A2. PRE ASSEMBLE THE FRAME, BRACES AND CENTER CHANNEL. SET UPSIDE DOWN ON THE LUMBER, SQUARE AND CENTER, AND MARK 2 HOLES IN EACH END OF THE BOARDS. ALSO MARK 2 HOLES IN EACH BOARD FOR THE CHANNEL
  3. MARK AND DRILL FOR SEAT BOARDS.
  4. ASSEMBLE TABLE PER ABOVE INSTRUCTIONS.

ITEM	QTY	DESCRIPTION
1	2	END SUPPORT FRAME
2	2	30" DIAGONAL BRACE
3	1	23" CENTER CHANNEL (WITH STRAIGHT EAR)
4	32	2 1/4" X 3/8" CARRIAGE BOLTS
5	5	1" X 5/16" HEX HEAD CAP SCREWS
6	32	3/8" SERRATED FLANGE NUTS
7	1	23" CENTER CHANNEL (WITH ANGLED EAR)
8	2	2 X 10 X 6' GRADE "C" SOUTHERN PINE
9	3	2 X 10 X 8' GRADE "C" SOUTHERN PINE
10	1	23" DIAGONAL BRACE
12	5	5/16" SERRATED FLANGE NUTS

<p>LENGTH OPTION</p> <input type="checkbox"/> 5' TABLE <input type="checkbox"/> 6' TABLE <input type="checkbox"/> 8' TABLE	<p>COLOR OPTIONS</p> <input type="checkbox"/> BROWN <input type="checkbox"/> GREEN
<p>STEEL OPTIONS</p> <input type="checkbox"/> PAINTED <input type="checkbox"/> BROWN <input type="checkbox"/> GREEN <input type="checkbox"/> HOT DIPPED GALVANIZED	<p>HARDWARE</p> <input type="checkbox"/> CARRIAGE BOLTS <input type="checkbox"/> GALVANIZED <input type="checkbox"/> STAINLESS STEEL
<p>WOOD OPTIONS</p> <input type="checkbox"/> GRADE "C" SOUTHERN PINE <input type="checkbox"/> GRADE "C" ACQ TREATED SOUTHERN PINE	

SCALE: NONE  
 DATE DRAWN: 3-11-09  
 DRAWN BY: CHG  
 DATE REVISED:  
 REVISED BY:

**GERBER MFG., LTD.**   
 2917 LATHAM DRIVE - MAIDSON, WI 53713  
**1-800-393-9923**

PICNIC TABLE  
 ASSEMBLY  
**158** or 238-8H SERIES  
 WHEELCHAIR ACCESSIBLE  
 TABLE- SINGLE OVERHANG

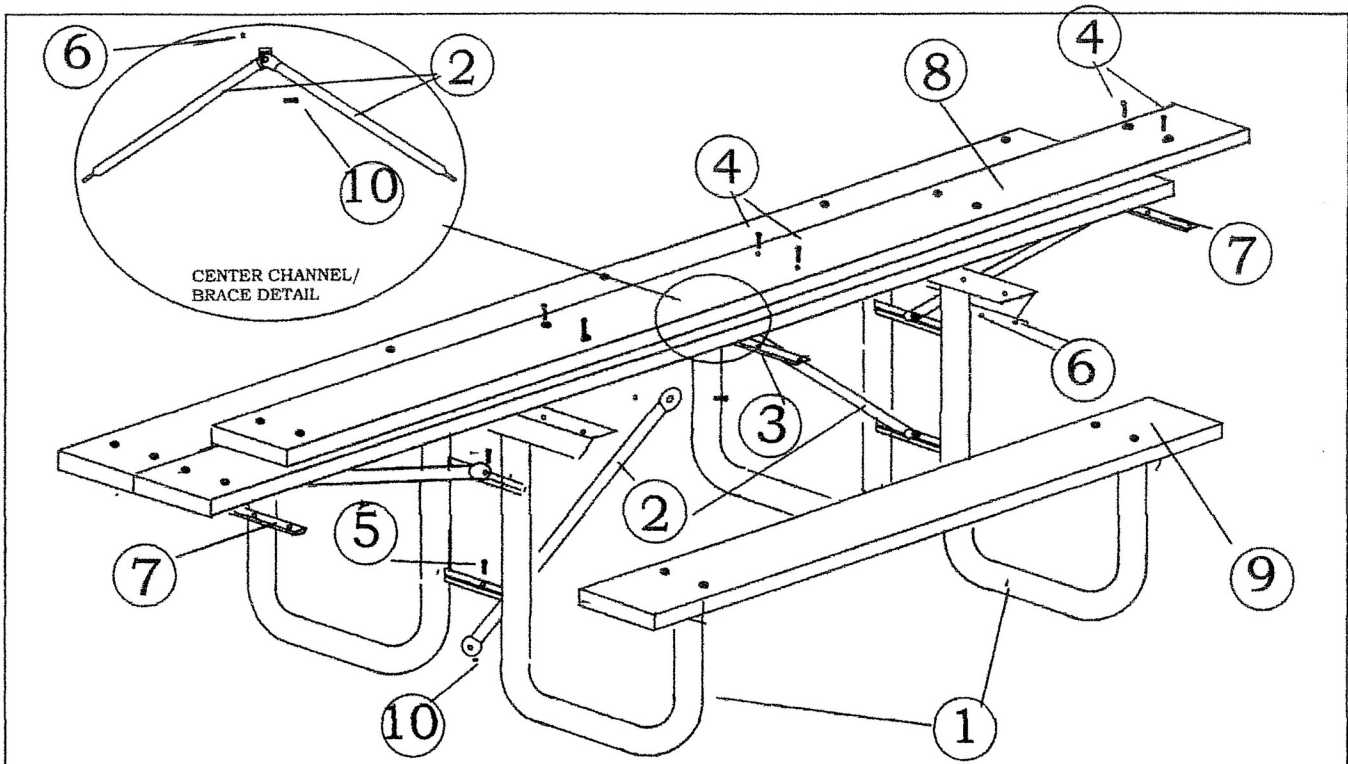

1. LAY 3 - 10' PLANKS, GOOD SIDE DOWN, ON FLAT CLEAN SURFACE WITH 2" CARRIAGE BOLTS INSERTED. NOTE: PLANKS ARE MARKED: "R" RIGHT TOP, "C" CENTER TOP, "L" LEFT TOP, "S" SEAT BOARDS.
2. ATTACH END FRAMES, USING 12 - 2" BOLTS.
3. ATTACH CENTER CHANNEL, USING 6 - 2" BOLTS.
4. ATTACH 30" DIAGONAL BRACES USING 3-1" BOLTS
5. ATTACH SEAT PLANKS, USING 4 - 2" BOLTS. THE "S" SHOULD BE ON THE SAME END AS "R" "C" "L".
6. ATTACH 27" DIAGONAL BRACES USING 2-1" BOLTS
6. ATTACH END CHANNELS USING 2" BOLTS.
7. ATTACH 27" DIAGONAL BRACES USING 1" BOLTS.
8. TIGHTEN ALL HARDWARE.

- NOTE:  
IF YOU HAVE PURCHASED THE LUMBER LOCALLY OR FROM US, NOT DRILLED, AND ARE USING CARRIAGE BOLTS PRE-DRILL AS FOLLOWS:
- A1. LAY 3 - 10' PLANKS, GOOD SIDE DOWN SPACED 1/4" APART ON A FLAT CLEAN SURFACE.
  - A2. PRE-ASSEMBLE, UPSIDE DOWN ON THE LUMBER, THE FRAME, CHANNELS AND BRACES. CENTER AND SQUARE THE FRAMES. USING THE FRAMES, AND CHANNELS, MARK 10 HOLES IN EACH BOARD.
  - A3. ATTACH LUMBER TO FRAMES AND CHANNELS.
  - A4. MARK AND DRILL FOR SEATBOARDS. ATTACH SEAT BOARDS.
  - A5. TIGHTEN ALL HARDWARE.

ITEM	QTY	DESCRIPTION
1	2	END SUPPORT FRAME
2	2	30" DIAGONAL BRACE
3	1	23" CENTER CHANNEL (WITH STRAIGHT EAR) <i>align</i>
4	38	2 1/4" X 3/8" CARRIAGE BOLTS
5	7	1" X 5/16" HEX HEAD CAP SCREWS
6	38	3/8" SERRATED FLANGE NUTS
7	2	23" CENTER CHANNEL (WITH ANGLED EAR) <i>monste</i>
8	3	2 X 10 X 10' GRADE "C" SOUTHERN PINE
9	2	2 X 10 X 6' GRADE "C" SOUTHERN PINE
10	7	5/16" SERRATED FLANGE NUTS

- HARDWARE**
- GALVANIZED
- STAINLESS STEEL
- STEEL OPTIONS**
- PAINTED
- COLOR OPTIONS**
- BROWN
- GREEN
- HOT DIPPED GALVANIZED
- WOOD OPTIONS**
- "C" GRADE SOUTHERN PINE
- "C" GRADE ACQ TREATED SOUTHERN PINE

SCALE:	NONE
DATE DRAWN:	3-28-06
DRAWN BY:	CHG
DATE REVISED:	
REVISED BY:	

**GERBER MFG., LTD.** 

2917 LATHAM DRIVE - MAIDSON, WI 53713

**1-800-393-9923**

PICNIC TABLE  
ASSEMBLY

238 -10H SERIES  
WHEELCHAIR ACCESSIBLE  
TABLE-DOUBLE OVERHANG

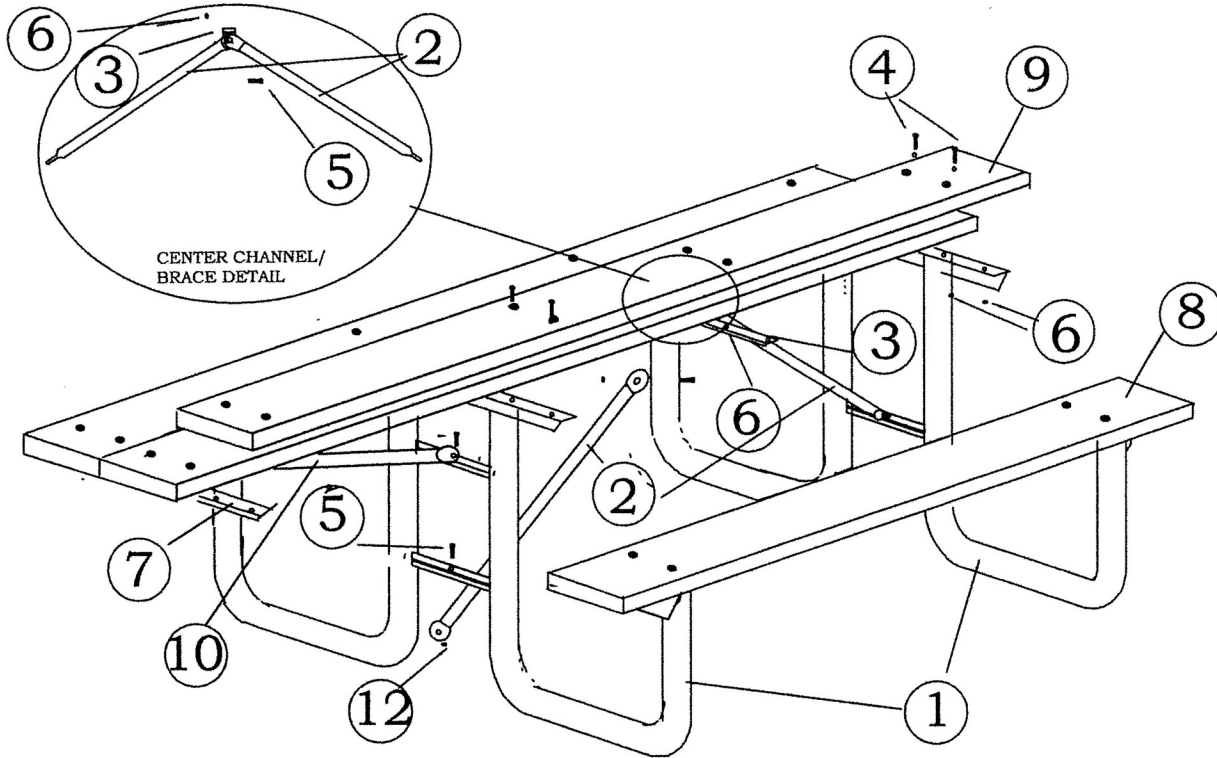

1. LAY 3 - 8' PLANKS, GOOD SIDE DOWN, ON FLAT CLEAN SURFACE WITH 2" CARRIAGE BOLTS INSERTED. NOTE: PLANKS ARE MARKED: "R" RIGHT TOP, "C" CENTER TOP, "L" LEFT TOP, "S" SEAT BOARDS.
2. ATTACH END FRAMES, USING 12 - 2" BOLTS.
3. ATTACH CENTER CHANNEL, USING 6 - 2" BOLTS.
4. ATTACH DIAGONAL BRACES, USING 3 - 1" BOLTS.
5. ATTACH SEAT PLANKS, USING 4 - 2" BOLTS. THE "S" SHOULD BE ON THE SAME END AS "R" "C" "L".
6. TIGHTEN ALL HARDWARE.

**NOTE:**

- IF YOU HAVE PURCHASED THE LUMBER LOCALLY OR FROM US, NOT DRILLED, AND ARE USING CARRIAGE BOLTS PRE-DRILL AS FOLLOWS:
- A1. LAY 3 - PLANKS, GOOD SIDE DOWN SPACED 1/4" APART ON A FLAT CLEAN SURFACE.
  - A2. PRE ASSEMBLE THE FRAME, BRACES AND CENTER CHANNEL. SET UPSIDE DOWN ON THE LUMBER, SQUARE AND CENTER, AND MARK 2 HOLES IN EACH END OF THE BOARDS. ALSO MARK 2 HOLES IN EACH BOARD FOR THE CHANNEL
  3. MARK AND DRILL FOR SEAT BOARDS.
  4. ASSEMBLE TABLE PER ABOVE INSTRUCTIONS.

ITEM	QTY	DESCRIPTION
1	2	END SUPPORT FRAME
2	2	30" DIAGONAL BRACE
3	1	23" CENTER CHANNEL (WITH STRAIGHT EAR)
4	32	2 1/4" X 3/8" CARRIAGE BOLTS
5	5	1" X 5/16" HEX HEAD CAP SCREWS
6	32	3/8" SERRATED FLANGE NUTS
7	1	23" CENTER CHANNEL, (WITH ANGLED EAR)
8	2	2 X 10 X 6' GRADE "C" SOUTHERN PINE
9	3	2 X 10 X 8' GRADE "C" SOUTHERN PINE
10	1	23" DIAGONAL BRACE
12	5	5/16" SERRATED FLANGE NUTS

<b>LENGTH OPTION</b>		<b>COLOR OPTIONS</b>	
<input type="checkbox"/> 5' TABLE	<input type="checkbox"/> BROWN	<input type="checkbox"/> BROWN	<input type="checkbox"/> GREEN
<input type="checkbox"/> 6' TABLE	<input type="checkbox"/> GREEN		
<input type="checkbox"/> 8' TABLE			
<b>STEEL OPTIONS</b>		<b>HARDWARE</b>	
<input type="checkbox"/> PAINTED	<input type="checkbox"/> CARRIAGE BOLTS	<input type="checkbox"/> GALVANIZED	<input type="checkbox"/> STAINLESS STEEL
<input type="checkbox"/> BROWN			
<input type="checkbox"/> GREEN			
<input type="checkbox"/> HOT DIPPED GALVANIZED			
<b>WOOD OPTIONS</b>			
<input type="checkbox"/> GRADE "C" SOUTHERN PINE			
<input type="checkbox"/> GRADE "C" ACQ TREATED SOUTHERN PINE			

SCALE:	NONE
DATE DRAWN:	3-11-09
DRAWN BY:	CHG
DATE REVISED:	
REVISED BY:	

**GERBER MFG., LTD.**

2917 LATHAM DRIVE - MAIDSON, WI 53713

**1-800-393-9923**

**PICNIC TABLE  
ASSEMBLY**

**238-8H SERIES  
WHEELCHAIR ACCESSIBLE  
TABLE- SINGLE OVERHANG**

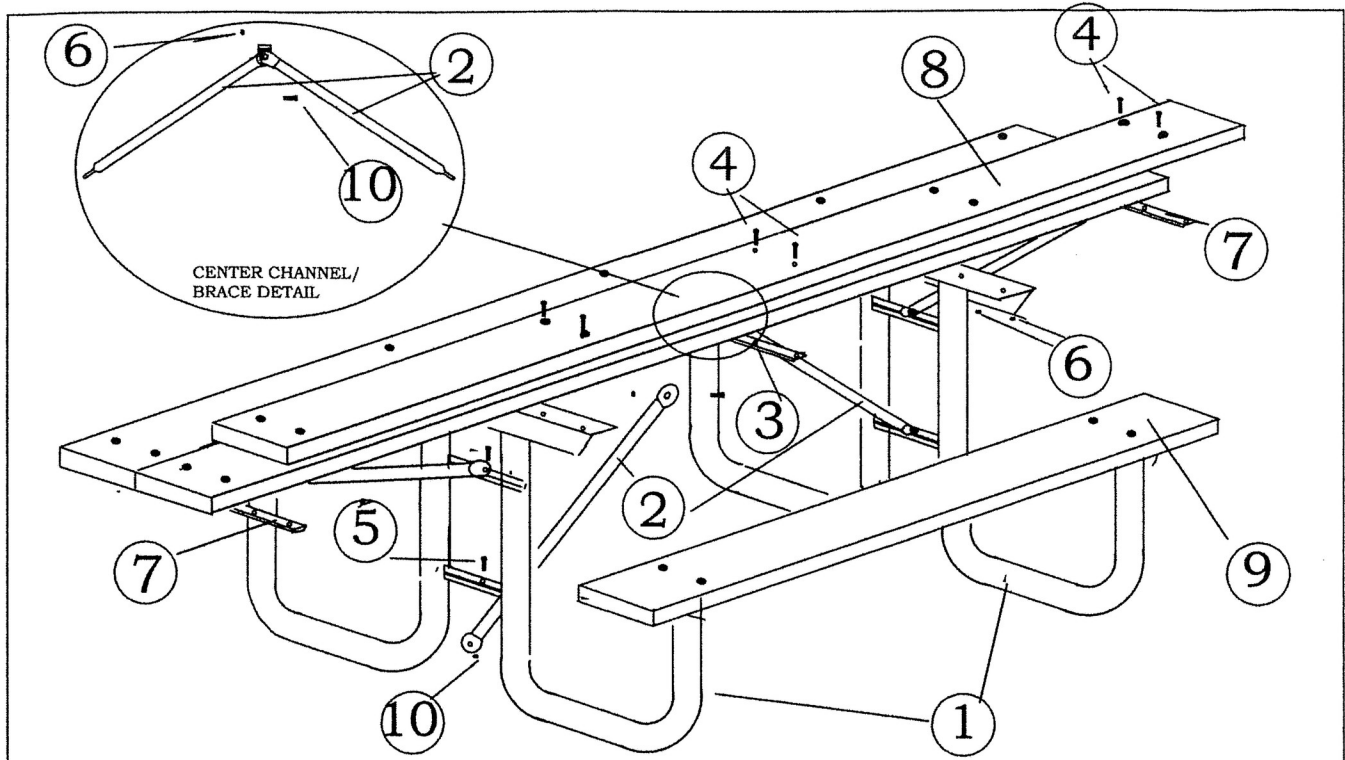

1. LAY 3 - 10' PLANKS, GOOD SIDE DOWN, ON FLAT CLEAN SURFACE WITH 2" CARRIAGE BOLTS INSERTED. NOTE: PLANKS ARE MARKED: "R" RIGHT TOP, "C" CENTER TOP, "L" LEFT TOP, "S" SEAT BOARDS.
2. ATTACH END FRAMES, USING 12 - 2" BOLTS.
3. ATTACH CENTER CHANNEL, USING 6 - 2" BOLTS.
4. ATTACH 30" DIAGONAL BRACES USING 3-1" BOLTS
5. ATTACH SEAT PLANKS, USING 4 - 2" BOLTS. THE "S" SHOULD BE ON THE SAME END AS "R" "C" "L".
6. ATTACH 27" DIAGONAL BRACES USING 2-1" BOLTS
6. ATTACH END CHANNELS USING 2" BOLTS.
7. ATTACH 27" DIAGONAL BRACES USING 1" BOLTS.
8. TIGHTEN ALL HARDWARE.

- NOTE:**  
IF YOU HAVE PURCHASED THE LUMBER LOCALLY OR FROM US, NOT DRILLED, AND ARE USING CARRIAGE BOLTS PRE-DRILL AS FOLLOWS:
- A1. LAY 3 - 10' PLANKS, GOOD SIDE DOWN SPACED 1/4" APART ON A FLT CLEAN SURFACE.
  - A2. PRE-ASSEMB, UPSIDE DOWN ON THE LUMBER, THE FRAME, CHANNELS AND BRACES. CENTER AND SQUARE THE FRAMES. USING THE FRAMES, AND CHANNELS, MARK 10 HOLES IN EACH BOARD.
  - A3. ATTACH LUMBER TO FRAMES AND CHANNELS.
  - A4. MARK AND DRILL FOR SEATBOARDS. ATTACH SEAT BOARDS.
  - A5. TIGHTEN ALL HARDWARE.

ITEM	QTY	DESCRIPTION
1	2	END SUPPORT FRAME
2	2	30" DIAGONAL BRACE
3	1	23" CENTER CHANNEL (WITH STRAIGHT EAR)
4	38	2 1/4" X 3/8" CARRIAGE BOLTS
5	7	1" X 5/16" HEX HEAD CAP SCREWS
6	38	3/8" SERRATED FLANGE NUTS
7	2	23" CENTER CHANNEL (WITH ANGLED EAR)
8	3	2 X 10 X 10' GRADE "C" SOUTHERN PINE
9	2	2 X 10 X 6' GRADE "C" SOUTHERN PINE
10	7	5/16" SERRATED FLANGE NUTS

- HARDWARE**
- GALVANIZED
  - STAINLESS STEEL
- STEEL OPTIONS**
- PAINTED
- COLOR OPTIONS**
- BROWN
  - GREEN
- HOT DIPPED GALVANIZED
- WOOD OPTIONS**
- "C" GRADE SOUTHERN PINE
  - "C" GRADE ACQ TREATED SOUTHERN PINE

SCALE:	NONE
DATE DRAWN:	3-28-06
DRAWN BY:	CHG
DATE REVISED:	
REVISED BY:	

**GERBER MFG., LTD.**   
 2917 LATHAM DRIVE - MAIDSON, WI 53713  
**1-800-393-9923**

PICNIC TABLE  
 ASSEMBLY  
**238-10H SERIES**  
 WHEELCHAIR ACCESSIBLE  
 TABLE-DOUBLE OVERHANG

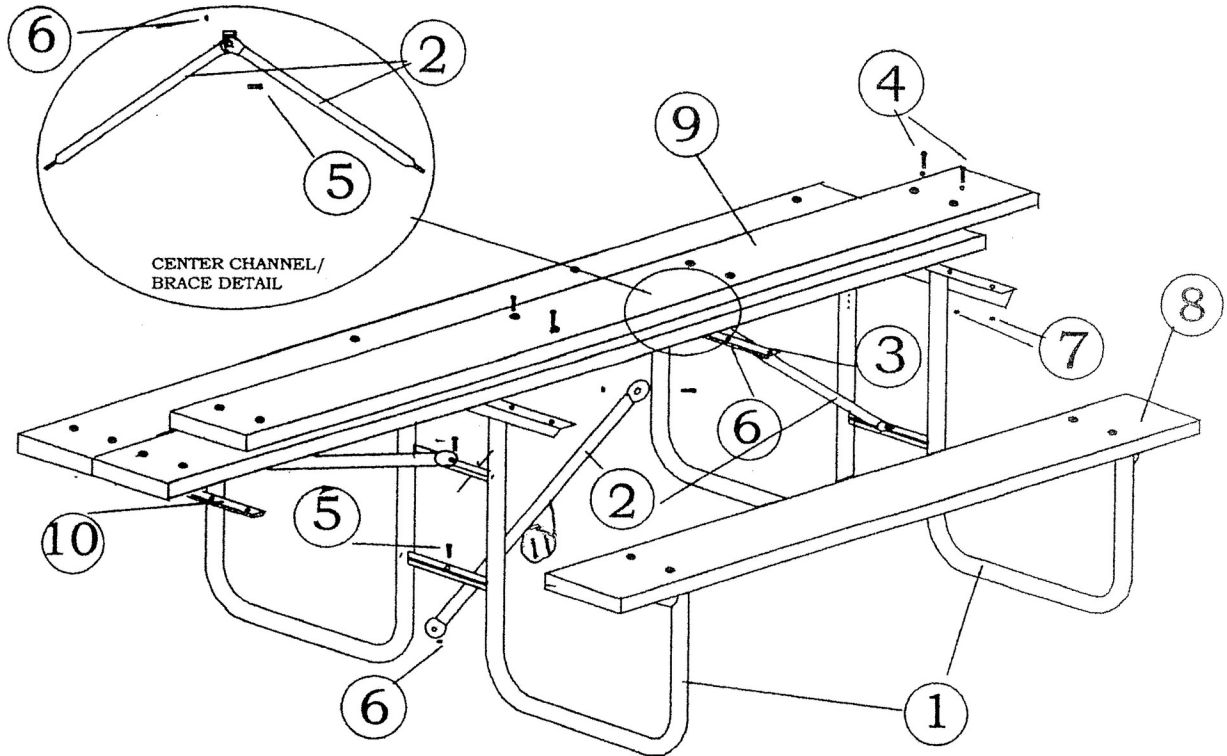

1. LAY 3 - 8' PLANKS, GOOD SIDE DOWN, ON FLAT CLEAN SURFACE WITH 2" CARRIAGE BOLTS INSERTED. NOTE: PLANKS ARE MARKED: "R" RIGHT TOP, "C" CENTER TOP, "L" LEFT TOP, "S" SEAT BOARDS.
2. ATTACH END FRAMES, USING 12 - 2" BOLTS.
3. ATTACH CENTER CHANNEL, USING 6 - 2" BOLTS.
4. ATTACH DIAGONAL BRACES, USING 3 - 1" BOLTS.
5. ATTACH SEAT PLANKS, USING 4 - 2" BOLTS. THE "S" SHOULD BE ON THE SAME END AS "R" "C" "L".
6. TIGHTEN ALL HARDWARE.

**NOTE:**

IF YOU HAVE PURCHASED THE LUMBER LOCALLY OR FROM US, NOT DRILLED, AND ARE USING CARRIAGE BOLTS PRE-DRILL AS FOLLOWS:

- A1. LAY 3 - PLANKS, GOOD SIDE DOWN SPACED 1/4" APART ON A FLAT CLEAN SURFACE.
- A2. PRE ASSEMBLE THE FRAME, BRACES AND CENTER CHANNEL. SET UPSIDE DOWN ON THE LUMBER, SQUARE AND CENTER, AND MARK 2 HOLES IN EACH END OF THE BOARDS. ALSO MARK 2 HOLES IN EACH BOARD FOR THE CHANNEL.
3. MARK AND DRILL FOR SEAT BOARDS.
4. ASSEMBLE TABLE PER ABOVE INSTRUCTIONS.

ITEM	QTY	DESCRIPTION
1	2	END SUPPORT FRAME
2	2	30" DIAGONAL BRACE
3	1	23" CENTER CHANNEL (WITH STRAIGHT EAR)
4	32	2" X 1/4" CARRIAGE BOLTS
5	5	1" X 5/16" HEX HEAD CAP SCREWS
6	5	5/16" SERRATED FLANGE NUTS
7	26	1/4" SERRATED FLANGE NUTS
8	2	2 X 10 X 6 "C" GRADE SOUTHERN PINE
9	3	2 X 10 X 8 "C" GRADE SOUTHERN PINE
10	1	23" CENTER CHANNEL (WITH ANGLED EAR)

**LENGTH OPTION**

- 5' TABLE
- 6' TABLE
- 8' TABLE

**COLOR OPTIONS**

- BROWN
- GREEN

**HARDWARE**

- CARRIAGE BOLTS
- LAG SCREWS

**STEEL OPTIONS**

- PAINTED
- HOT DIPPED GALVANIZED

**WOOD OPTIONS**

- "C" GRADE SOUTHERN PINE
- "C" GRADE ACQ TREATED SOUTHERN PINE

11 1 27" DIAGONAL BRACE

SCALE:	NONE
DATE DRAWN:	3-11-09
DRAWN BY:	CHG
DATE REVISED:	
REVISED BY:	

**GERBER MFG., LTD.**

2917 LATHAM DRIVE - MAIDSON, WI 53713

**1-800-393-9923**

PICNIC TABLE  
ASSEMBLY

**11-8 H SERIES**  
WHEELCHAIR ACCESSIBLE  
TABLE- SINGLE OVERHANG

- 1) LAYOUT LUMBER FOR TOP ASSEMBLY, (3- 2 X 10'S) ON A CLEAN, LEVEL SURFACE BEST SIDE DOWN. LEAVE 1/4" SPACING BETWEEN BOARDS. KEEP ENDS FLUSH.
- 2) IF LUMBER IS PREDRILLED, BOARDS WILL BE MARKED WITH "L,C,R," FOR THE TOP ASSEMBLY, SEAT BOARDS WILL BE MARKED WITH AN "S". PLACE CARRIAGE BOLTS IN HOLES & TAP HEAD OF BOLTS LIGHTLY TO SEAT CARRIAGE HEAD INTO LUMBER. SQUARE UP TOP ASSEMBLY & FASTEN ALL HARDWARE AS FOLLOWS.
- 3) ATTACH CENTER CHANNEL THAT HAS TAB WELDED PERPENDICULAR TO CHANNEL, (ADA CENTER CHANNEL). SQUARE UP CENTER CHANNEL FROM END OF TABLE TOP MATERIAL TO EITHER SIDE OF TOP ASSEMBLY. LOCATE EQUALLY FROM EACH SIDE AND 8" FROM END OF LUMBER TO CENTER LINE OF HOLES IN CENTER CHANNEL. FASTEN SECURELY WITH (10) 1/4" X 1 1/4" LAG SCREWS.
- 4) ATTACH 27" BRACE TO EAR OF CENTER CHANNEL. ALL FASTENING POINTS OF BRACES USE A 5/16" BOLT, NUT, AND LOCKWASHER. FINGER TIGHTEN ONLY! ATTACH OTHER END OF BRACE TO THE END FRAME WHICH HAS TWO ANGLE IRONS BETWEEN THE UPRIGHTS OF THE FRAME. FASTEN ON ANGLE IRON NEAREST TABLETOP. FINGER TIGHTEN ONLY.
- 5) ATTACH 30" BRACE TO SAME END FRAME AT THE ANGLE IRON FARTHEST FROM TABLE TOP SURFACE. FASTEN OTHER END OF BRACE TO REGULAR CENTER CHANNEL ALONG WITH THE REMAINING 30" BRACE.
- 6) FOR A SINGLE OVERHANG ASSEMBLY ATTACH OTHER END OF 30" BRACE TO REMAINING END FRAME WHICH HAS ONE ANGLE IRON BETWEEN THE UPRIGHTS OF THE FRAME. THEN PROCEED TO STEP 7.  
FOR A DOUBLE OVERHANG ASSEMBLY ATTACH OTHER END OF 30" BRACE TO REMAINING END FRAME WHICH HAS TWO ANGLE IRONS BETWEEN THE UPRIGHTS OF THE FRAME. FASTEN 30" BRACE TO ANGLE IRON FARTHEST AWAY FROM TABLE TOP SURFACE. FINGER TIGHTEN ONLY. ATTACH 27" BRACE TO ANGLE IRON NEAREST TABLE TOP SURFACE. FASTEN OTHER END OF 27" BRACE TO REMAINING CENTER CHANNEL WITH TAB WELDED PERPENDICULAR TO CENTER CHANNEL, (ADA CENTER CHANNEL). SQUARE UP CENTER CHANNEL TO EITHER SIDE OF TOP ASSEMBLY AND FASTEN SECURELY WITH (10) 1/4" X 1 1/4" LAG SCREWS.
- 7) SQUARE UP END FRAMES & LOCATE INTO PLACE REGULAR CENTER CHANNEL ON SURFACE OF LUMBER.
- 8) SECURE END FRAMES AND REGULAR CENTER CHANNEL WITH EITHER LAG SCREWS (12 LAG SCREWS PER END FRAME- 10 LAG SCREWS FOR CENTER CHANNEL) OR (6) CARRIAGE BOLTS PER END FRAME AND (6) CARRIAGE BOLTS PER CENTER CHANNEL.
- 9) FOR FASTENING SEAT BOARDS ON A SINGLE OVERHANG LOCATE SEAT BOARD TO BE FLUSH WITH TABLE TOP AT OPPOSITE END OF OVERHANG. SECURE SEAT BOARDS WITH EITHER 9 LAG SCREWS OR 4 CARRIAGE BOLTS PER SEAT BOARD. DRILL 4 HOLES, 1/16" LARGER THAN BOLT DIAMETER. FOR FASTENING SEAT BOARDS FOR DOUBLE OVERHANG LOCATE SEAT BOARDS TO BE AN EQUAL DISTANCE FROM EACH BOARD END TO EDGE OF END FRAME. SECURE SEATS WITH EITHER 9 LAG SCREWS OR 4 CARRIAGE BOLTS PER SEAT BOARD. FOR CARRIAGE BOLT APPLICATION DRILL 4 HOLES 1/16" LARGER HOLE THAN CARRIAGE BOLT DIAMETER.
- 10) USING APPROPRIATE WRENCH OR SOCKET SECURE ALL HARDWARE TIGHTLY.

**IF YOU HAVE ANY QUESTIONS REGARDING THE ASSEMBLY OF THIS TABLE  
PLEASE CALL (800) 393-9923.**

**REV 3-21-00**

**THANK YOU FOR PURCHASING A GERBER!**